

WHAT YOU'LL NEED

1-POINT WIRE (x4)

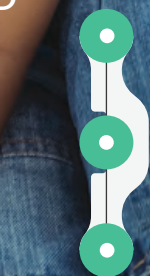

2-POINT WIRE (x2)



3-POINT WIRE (x1)

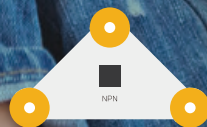

ELECTRIC SWITCH (x1)



RED LED (x1)



TOUCH BUTTON (x1)



BATTERY (x1)

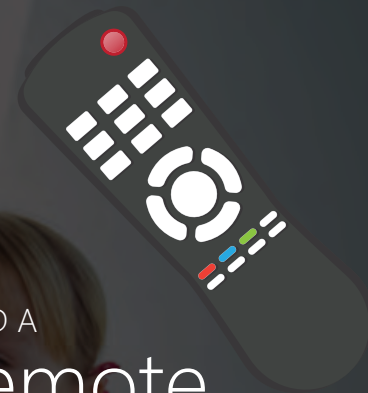

BUILD A

Remote Control LED

WHAT YOU'LL LEARN

The touch button is a type of switch.

When your finger is on the sensor, your skin connects the two sides, like a bridge over a river, so the current can go across.



Magnetic, snap-together modules
for learning basic circuitry

BUILD A

Remote Control LED



Magnetic, snap-together modules
for learning basic circuitry

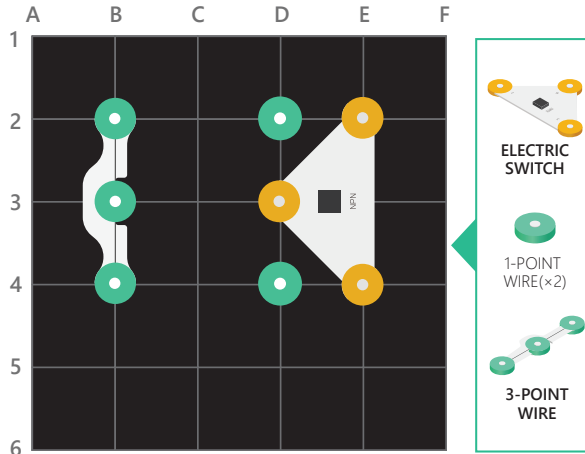

Step 1: Place the NPN, two 1-point wire components and one 3-point wire component on the board as shown.

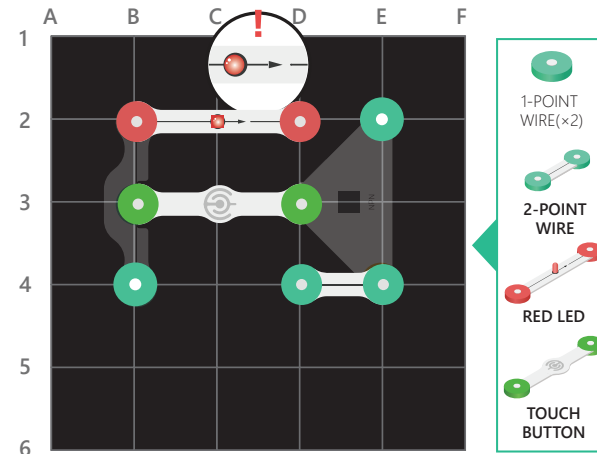

Step 2: Place two 1-point wire components, one 2-point wire component, the red LED, and the touch button on top of the pieces from step 1, as shown.

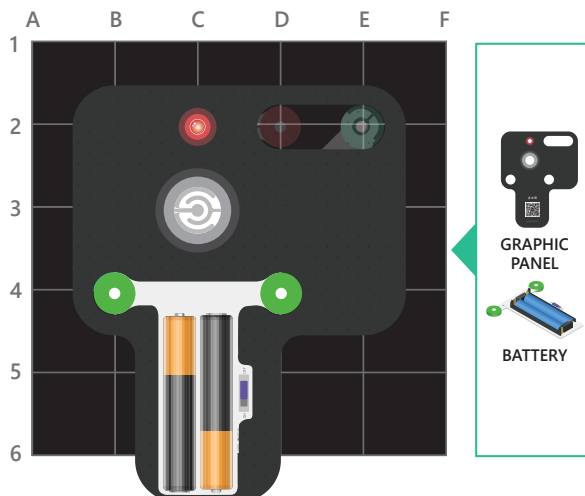

Step 3: Add graphic panel and battery. Flip switch on battery to "ON" position.

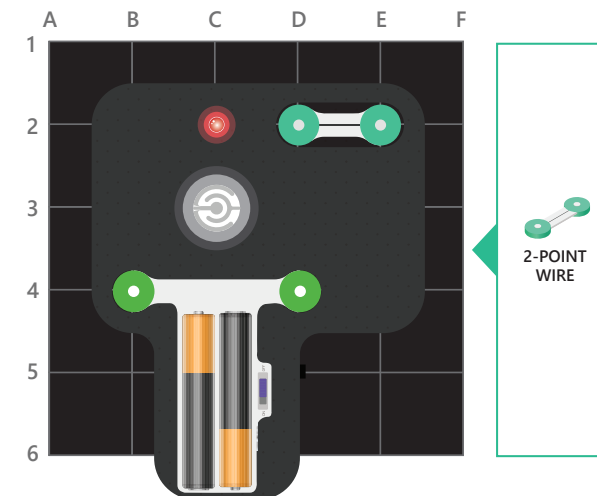

Step 4: Place one 2-point wire component on top of the pieces from step 3, as shown.

